



STW146



STW146-2P

## BURNER ACCESSORIES

No.	Description	QTY
1	Transfer oil pump	1PC
2	Air controller	1PC
3	Install flange	1PC
4	Asbestos gasket	1PC
5	Outlet-inlet pipe	2PC

No.	Description	QTY
6	Install screw	4PC
7	Inner six angle spanner	1PC
8	Nozzle spanner	1PC
9	Oil filter	1PC
10	Oil line connector	4PC

## TECHNICAL DATA

Model	Cap. (KW)	Motor	Nozzle Qty	Combustion (KG)	Transfer Motor	Power Supply
STW120-P	10-50	130W	1	1-4	120W	230V/50Hz
STW120	12-50	90W	1	1-4	120W	230V/50Hz
STW133-1	40-80	130W	1	3-7	180W	230V/50Hz
STW133-1P	40-80	180W	1	3-7	180W	230V/50Hz
STW133-2P	70-115	220W	2	6-10	180W	230V/50Hz
STW133-2	70-115	130W	2	6-10	180W	230V/50Hz
STW146-2	70-139	150W	2	6-12	180W	230V/50Hz
STW146-2P	70-139	250W	2	6-12	180W	230V/50Hz
STW146-3	115-200	180W	3	10-18	180W	230V/50Hz

## DESCRIPTION

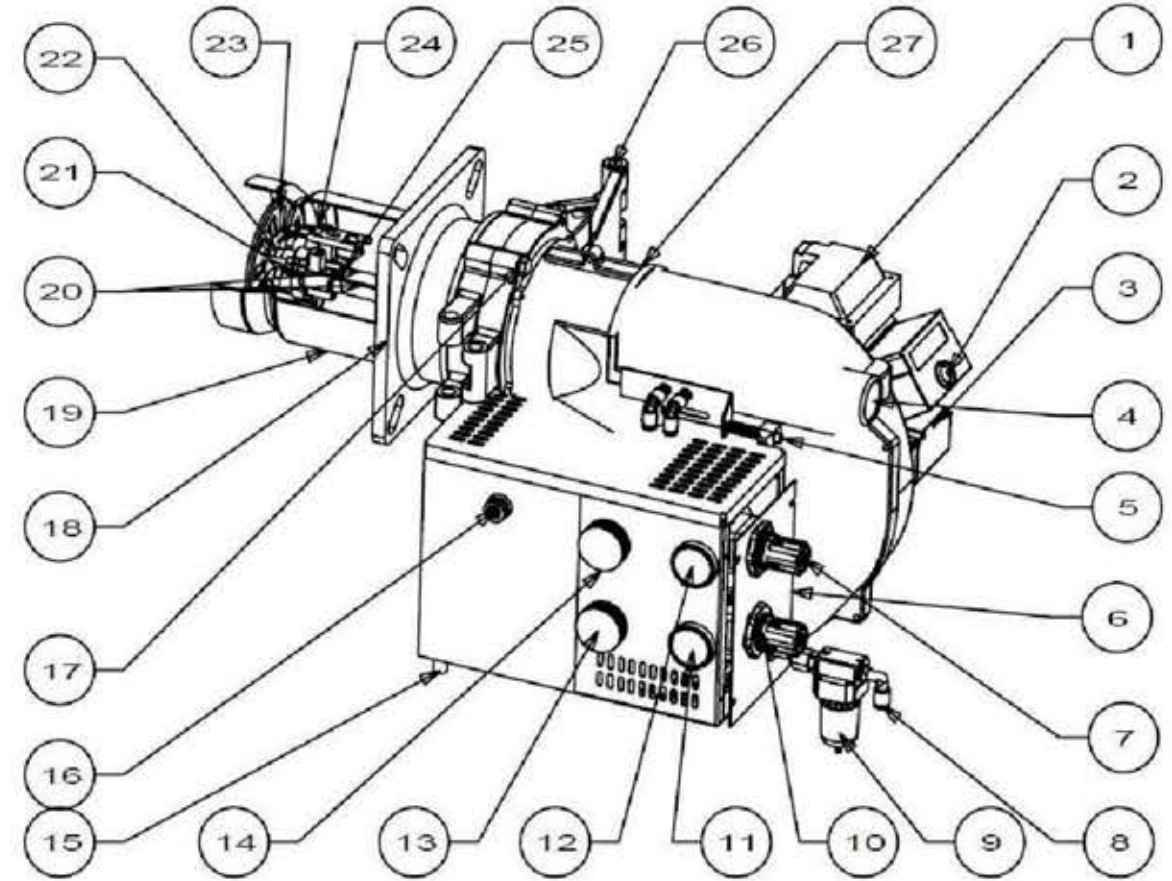

1. Ignition transformer	8. Compressor air inlet	15. Overflow connector	22. Fuel nozzle
2. Controller	9. Air filter	16. Oil inlet	23. Flame disc
3. Seven pin socket	10. Big flame adjustor	17. Fixing-screw of rock arm	24. Ignition electrode
4. Flame mirror	11. Big flame pressure switch	18. Install flange	25. Heater
5. 2nd-Air adjustor	12. Ignition pressure switch	19. Blast tube	26. Rock arm
6. Air damper	13. 2nd temperature controller	20. Air pipe	27. Burner body
7. Pressure adjustor	14. 1st temperature controller	21. Nozzle base	